

Better value, delivered.



# Primary School Furniture Planning Guide



Find out more...

www.

[ypo.co.uk/furniture](http://ypo.co.uk/furniture)

# Transforming Tired Teaching Spaces

Whether you're in charge of an entire school refit or looking at refreshing a room or two, it can be difficult to know where to start. This booklet has been designed to give a little guidance and inspiration to help kick start your project.

We've provided some example layouts for classrooms, halls and dining rooms, reception areas, offices, staff rooms and libraries, as well as details of the products you'd need to complete the space and an estimated cost for the refurbishment. Hopefully this will make the task of planning your space and choosing the right furniture a little less daunting.

When you're ready to take the next step, get in touch with our experienced team who will provide you with a free consultation on your bespoke requirements. We'll design and project manage your refurb. This includes managing deliveries and providing an installation team to off-load deliveries and place into position. We also offer full after sales advice and support.

Call **01924 834 886** or email **designenquiries@ypo.co.uk** for further information.

## Contents

What our customers say...	03	Group room	13
Nursery classroom	04	Meeting room	13
Reception classroom	06	Medical room	13
Key stage 1 classroom	08	Offices	13-14
Key stage 2 classroom	10	Staff room	14
Hall and dining room	12	Library	15
Reception area	13		

### Transforming a staff room into a new science lab at Eskdale School

*"Working with YPO gave us security for this first project, we have many more rooms to re-develop, including another science lab, so we'll be continuing to work with YPO to help make the changes. They made it so easy and we had the assurance that we were working with people who knew what they were doing. They held our hand throughout, were always on the end of a phone, and gave us good advice. They couldn't do enough, they were there to help."*

**Trevor Parker** - Site Manager



### Brand new school fit out at Aberdare Community School

*"Working with YPO was a highly positive experience. Due to a tight timetable, the construction of the school had not finished before furniture had to be moved into the school. YPO was on-hand to assist with our project management from the start and helped us select a range of products to meet our design needs within the time frame to a very high standard."*

**Helen Evans** - Corporate Estates

### New sixth form centre unveiled at Meadowhead School Academy Trust

*"We have had extensions and developments at Meadowhead in the past but never anything on this scale. Our aim was to create a space that provided additional teaching rooms and social spaces but was also conducive to private study. Equally we wanted a facility that would support student aspirations. As soon as we consulted with Alex Wainwright (YPO Project Manager) we were confident she fully understood what we required and knew how to deliver it."*

*As the project progressed and we had to modify some aspects of the design layout, furniture and materials. YPO were always supportive and facilitated changes with care as the scheme developed. A productive working relationship with YPO kept the project moving forward with ease."*

**Matt Furniss** - Deputy Business Manager





# Nursery Classroom



Nursery layouts tend to be split into zones such as role play, carpet area, reading corner, messy play and teaching areas. Storage units can help split up these areas and provide useful display and storage solutions.



Product type	Product name	Quantity	Notes
Chairs	Infant chair	30	
	Staff chair	3	
Tables	Rectangular table	6	
	Trapezoidal table	2	
	Minibeast table	2	
	Flower table	1	
	Arc table	2	
Role play	Play panel set	1	
	Early years kitchen	1	
	Dress up station and mirror	1	
	2-sided easel	1	
Soft furnishings	Tub sofa	1	
	Tub chair	1	
	5 x seating pods	2	
Storage and accessories	Alphabet rug	1	
	Wet play unit	1	
	Kinderbox plastic tray unit (with trays)	1	
	Mobile tall book display	1	
	Mobile tall unit with display divider and mirror	1	
	4 x 4 deep tray storage unit	1	
	Triple column shallow tray storage unit	1	
	Double column shallow tray storage unit	1	
Caterpillar book storage	1		



When choosing colours, the current trend is natural looking furniture, i.e. wooden tables and cupboards and wicker basket storage, but colour can be introduced when choosing the chairs, trays, rugs, seating and displays on walls.

 **Estimated cost: £4,300**



# Reception Classroom

Reception classrooms are a continuation of the nursery environment, with learning zones to help promote learning through play. Separate teaching areas can be created for subjects such as small world, construction, maths, reading, music, computers and phonics.



Product type	Product name	Quantity	Notes
<b>Chairs</b>	Infant chair	30	
	Staff chair	3	
<b>Tables</b>	Rectangular table	2	
	Trapezoidal table	4	
	Circular table	1	
	Flower table	1	
	Arc table	2	
<b>Role play</b>	Play panel set	1	
	Early years kitchen	1	
	Dress up station and mirror	1	
<b>Soft furnishings</b>	Quilted tub sofa	1	
	Quilted tub chair	1	
	5 x stackable seat pods	2	
	Large numbers learning rug	1	
<b>Storage and accessories</b>	Kinderbox plastic tray unit (with trays)	1	
	4 x 4 deep tray storage unit	2	
	Triple column shallow tray storage unit	1	
	Double column shallow tray storage unit	1	

 **Estimated cost: £3,600**



*Have you thought about outdoor classrooms, wooden planters and learning sheds?*

All the furniture we supply is durable, versatile, hardwearing and designed with safety in mind. Each item is tested to the current British standard and comes with a guarantee.





# Key Stage 1 Classroom



KS1 classrooms can be adapted for group work and individual learning. Storage can be positioned next to walls and reading corners can be utilised if space allows.

Product type	Product name	Quantity	Notes
<b>Chairs</b>	Infant chair	30	
	Staff chair	3	
	Operator chair	1	
<b>Soft furnishings</b>	Giant multiway bean bags	3	
<b>Tables</b>	Rectangular table	15	
	Arc table	1	
<b>Storage and accessories</b>	Kinderbox plastic tray unit (with trays)	1	
	Large book display	1	
	Rectangle rug	1	
	Triple column	2	
	Curved shelving	1	
	4 x 4 Deep tray storage	1	

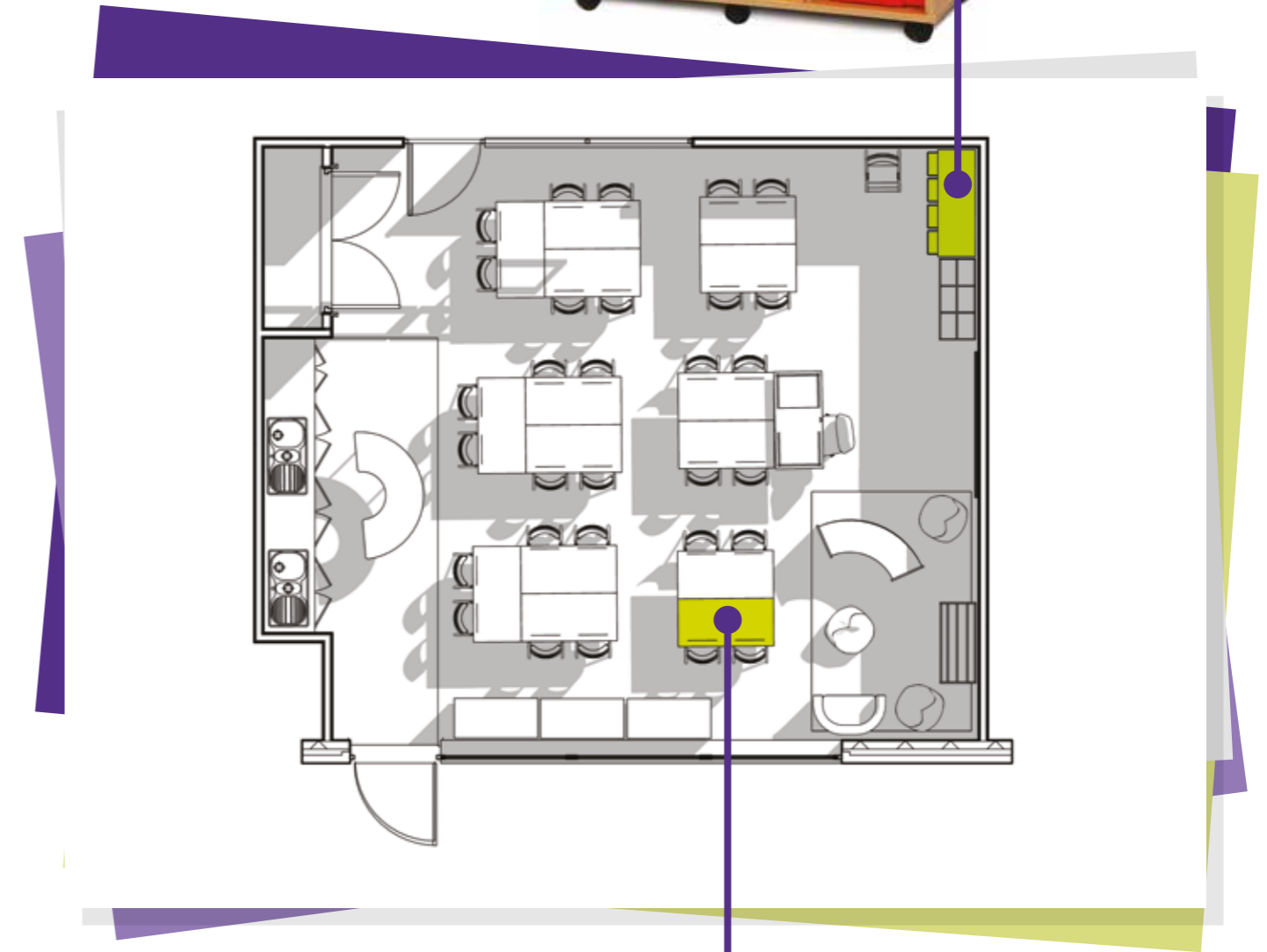

 **Estimated cost: £3,000**



*Have you thought about lunchbox trolleys and a display board?*

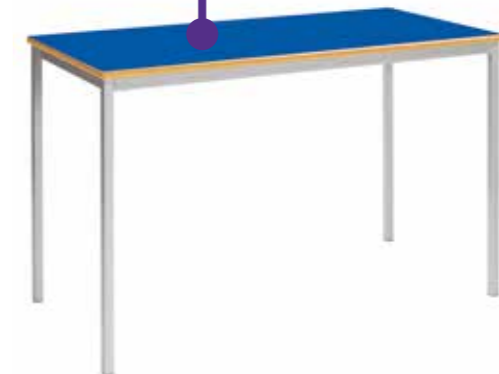

Display boards and topic specific whiteboards are a great way to display pupils' work and achievements in each classroom.

# Key Stage 2 Classroom



KS2 classrooms are set up to be versatile but learning tends to be more forward facing and each pupil should be able to see the teaching wall.

Product type	Product name	Quantity	Notes
<b>Chairs</b>	Infant chair	30	
	Staff chair	3	
<b>Soft furnishings</b>	Hexagonal stool seats	2	
<b>Tables</b>	Rectangular table	15	
	Teacher's desk	1	
<b>Storage and accessories</b>	Open bookshelf	1	
	Quad column tray unit	2	
	Rectangle rug	1	
	Triple column	3	
	Curved shelving	2	

 **Estimated cost: £2,800**

 *Have you thought about laptop/tablet charging trolleys and cloakroom furniture?*

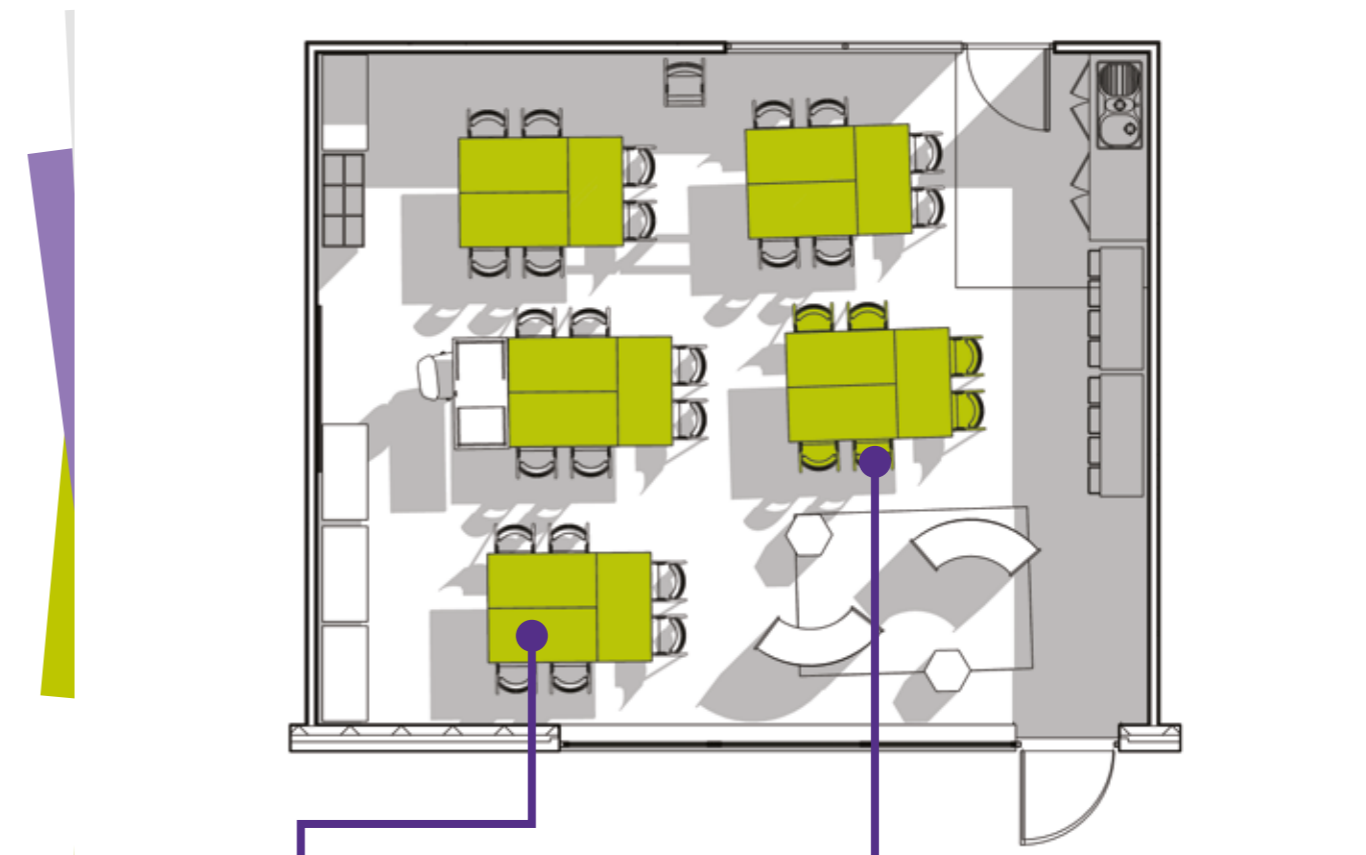

The heights of furniture vary in primary schools and we recommend trying sample chairs when choosing heights.



# Hall and Dining Room

Product name	Quantity	Notes
Non-linking folding chair (for assembly and school productions)	100	
Chair storage trolley	2	
Recycling bin	3	
12 seater folding table	10	
16 seater folding table	9	

 **Estimated cost: £9,600**

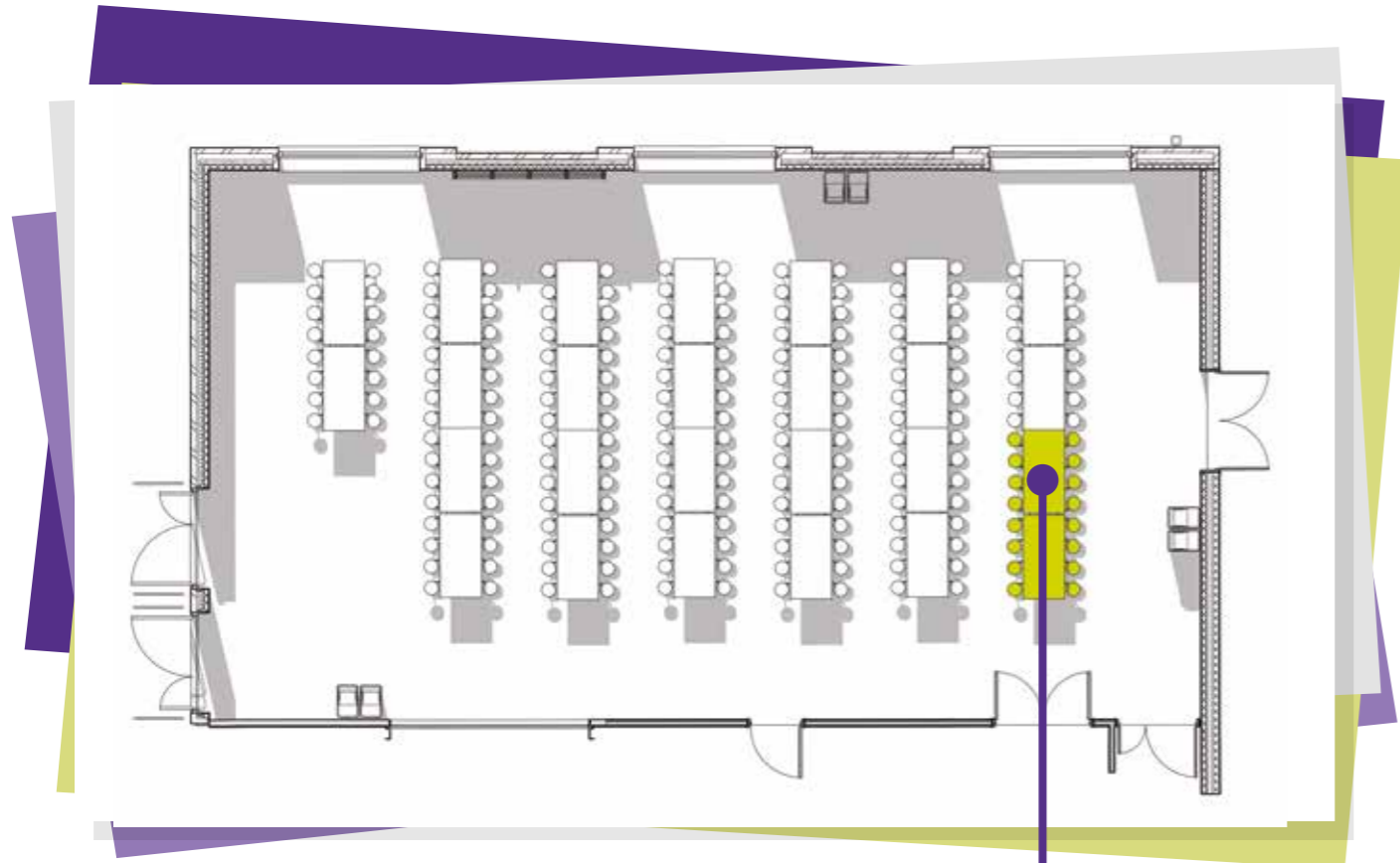

 *Have you thought about sports equipment and staging systems?*

# Headteacher's Office

Product name	Quantity	Notes
Small meeting table	1	
Meeting chair	4	
Office desk	1	
Operator's chair	1	
Desk pedestal	1	
Tall lockable filing cabinet	1	
Lockable cupboard	1	
Shelves	1	
Bin	1	

 **Estimated cost: £1,600**

# Medical Room

Product name	Quantity	Notes
Computer desk	1	
Staff desk chair	1	
Treatment couch	1	
Tall filing cabinet	1	
Bookcase	1	
Pharmacy fridge - counter top	1	
Medical cabinet	1	

 **Estimated cost: £1,500**

 *Have you thought about display cabinets, noticeboards, leaflet displays and a reception counter?*

# Group Room

Product name	Quantity	Notes
Table	5	
Chair	10	
Tray unit	1	
Bookcase	1	
Bin	1	

 **Estimated cost: £850**

# Meeting Room

Product name	Quantity	Notes
Conference table	6	
Meeting chair	12	
Bookcase	1	
Bin	1	

 **Estimated cost: £1,600**

# Reception

Product name	Quantity	Notes
Beech armless chair	3	
Coffee table	1	

 **Estimated cost: £400**

# Deputy Headteacher's Office Interview Room

Product name	Quantity	Notes
Office desk	1	
Operator's chair	1	
Bookcase	1	
Desk high pedestal	1	
Bin	1	
Meeting chair	2	

 **Estimated cost:**  
£1,000

# Admin Office Staff Room

Product name	Quantity	Notes
Staff desk chair	2	
Office desk	2	
Tall filing cabinet	1	
Small filing cabinet	1	
Tall cabinet	1	
Shelves	4	
Bin	2	

 **Estimated cost:**  
£1,500

 *Have you thought about fridges, washing machines, dishwashers, photocopiers and safes?*

Product name	Quantity	Notes
Staff chair	6	
Oblong table	2	

 **Estimated cost:**  
£300

Product name	Quantity	Notes
Pigeon hole unit	1	
Oblong table	5	
Meeting chair	10	
Upholstered chair	20	
Bin	2	

 **Estimated cost:**  
£3,300



# Library

Product name	Quantity	Notes
Library shelving unit (single sided)	12	
Kinder box	2	
Table	2	
Chair	6	
Rug	2	
Computer workbench	1	
Low level seat	2	
Stools	3	
Reading den	2	
Book display unit	1	
Curved upholstered benches	2	
Installation of above	1	

 **Estimated cost:** £8,000



# Contact us

For more information about primary school furniture planning contact our team today:

 01924 834 886

 [designenquiries@ypo.co.uk](mailto:designenquiries@ypo.co.uk)

 [ypo.co.uk/furniture](http://ypo.co.uk/furniture)

